

RECOMMENDED PCB LAYOUT
TOP VIEW (.XX±0.05)

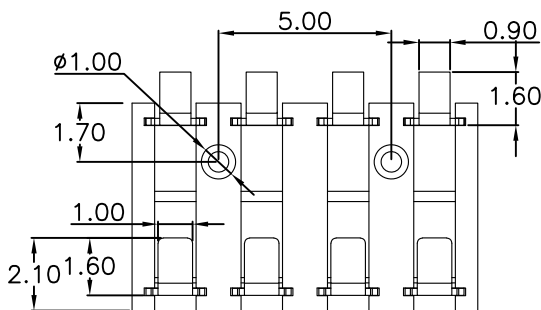

性能:

额定电流: 2.0A

额定电压: 12V

耐电压: 500V

接触电阻: 30mΩ MAX

绝缘电阻: 500MΩ

工作温度: -40℃~+85℃

使用寿命: 5000次以上

塑件(材质): LCP BLACK

接触点(材质): 黄铜C2680,

接触面镀金3U, 焊脚镀金1U



深圳市华宇创精密电子有限公司

2014-02-23

TOLERANCE: X.X ±0.30 X.XX ±0.25 X.XXX ±0.15 X' ±2' X.X' ±0.5'	DRAWN BY : 陈一鸣	DATE :	PART NAME: 2.5PH 3.4H 4P 母座有柱
	CHECKED BY: 马跃	DATE : 2014-02-23	PART NO. HVC-BF4P2534D-50
UNIT: mm [inch] SCALE:1:1 SIZE: A4	APPROVED BY: 邱敏	DATE : 2014-02-23	MOLD NO.
			DRAW NO: HVC-2604101041
			SHEET NO. 1 OF 1