

SECTION:A-A

Specification:

1. Rating : DC 20V 5A;
2. Contact resistance: $\leq 30m\Omega$;
After test: $\leq 50m\Omega$
3. Insulation resistance: $\geq 100M\Omega$ (500VDC);
After test: $\geq 50M\Omega$
4. Withstand voltage: 500VAC ;
5. Insertion and extraction force: 3N~30N;
6. life test: 5000cycles min;
7. Operation temperature range: -20°C~70°C
8. Preservative temperature range: -40°C~85°C

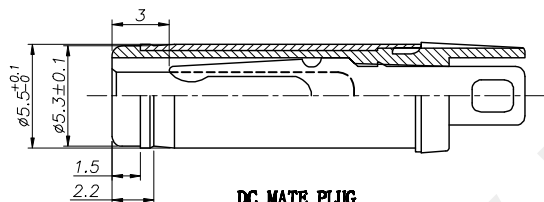

DC MATE PLUG

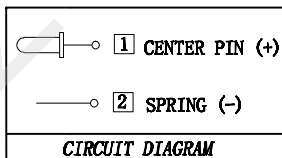

□ : TERMINAL NO.

PIN	2.0	2.5
-----	-----	-----



深圳市华宇创精密电子有限公司

TOLERANCE: X.X ±0.30 X.XX ±0.25 X.XXX ±0.15 X' ±2' X.X' ±0.5'	DRAWN BY : 陈一鸣	DATE : 2014-02-23	PART NAME: DC-071立式
	CHECKED BY: 马跃	DATE : 2014-02-23	PART NO. : HYC-DC071-XXX
UNIT: mm [inch] SCALE:1:1 SIZE: A4	APPROVED BY: 邱敏	DATE : 2014-02-23	MOLD NO. : /
			DRAW NO. : HYC-2204231153
			SHEET NO. : 1 OF 1