

P. C. B Layout
(Copper-sided view)

PIN	∅2.0	∅2.35	∅2.5
-----	------	-------	------

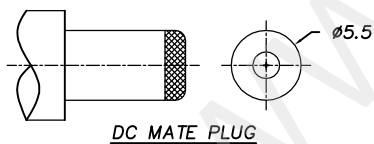

SPECIFICATION

1. Rating : DC 20V 2A;
2. Contact resistance: $\leq 50m\Omega$;
3. Insulation resistance: $\geq 100M\Omega$ (DC500V);
4. Withstand voltage: 500VAC ;
5. Insertion and extraction force: 3-30N;
6. life test: 5,000 cycles;
7. Operation temperature range: $-20^{\circ}C \sim 70^{\circ}C$;
8. Preservative temperature range: $-40^{\circ}C \sim 85^{\circ}C$;
9. Sign "▲" is importance dimension .

NO.	DESCRIPTION	QTY	MATERIAL	REMARK
⑥	Shunt terminal	1	Brass t=0.3	Silver plating
⑤	Tip spring	1	Mn steel t=0.2	Silver plating
④	Center pin terminal	1	Brass t=0.3	Silver plating
③	Center pin	1	Brass	CuSn/Nickel plating
②	Cover	1	PF	
①	Housing	1	PBT	



深圳市华宇创精密电子有限公司

TOLERANCE: X.X ±0.30 X.XX ±0.25 X.XXX ±0.15 X.* ±2* X.X* ±0.5*	DRAWN BY : 陈一鸣	DATE : 2014-02-23	PART NAME: DC-012D 短脚
	CHECKED BY: 马跃	DATE : 2014-02-23	PART NO. : HYC-DC012D-XXX
UNIT: mm [inch] SCALE: 1:1 SIZE: A4	APPROVED BY: 邱敏	DATE : 2014-02-23	DRAW NO. : HYC-2112131201
			SHEET NO. : 1 OF 1